

Feb 28, 2024 - 10:14am

CONSTRUCTION PLANS FOR  
CITY CONTRACT NO. 2024-02

SUNSET AVENUE/TAFT STREET PEDESTRIAN CROSSING IMPROVEMENTS  
SUNSET AVENUE AT TAFT STREET, ANALY HIGH SCHOOL  
CITY OF SEBASTOPOL, CALIFORNIA

GENERAL NOTES: (APPLIES TO ALL SHEETS)

- ALL MATERIAL, WORKMANSHIP, AND CONSTRUCTION SHALL CONFORM TO THE CITY OF SEBASTOPOL 2021 STREET STANDARDS, THE 2023 CALTRANS STANDARD PLANS (CSP) AND SPECIFICATIONS, AND THE 2014 CALIFORNIA MANUAL ON UNIFORM TRAFFIC CONTROL DEVICES (CA-MUTCD) LATEST REVISION.
- WORK HOURS ARE LIMITED TO MONDAY THROUGH FRIDAY, 7:00 AM. TO 5:30 P.M. INSPECTION WILL BE AVAILABLE MONDAY THROUGH FRIDAY FROM 8:00 AM. TO 4:00 P.M. CONTRACTORS SHALL SCHEDULE INSPECTIONS 48 HOURS IN ADVANCE.
- ANY DISCREPANCY DISCOVERED BY CONTRACTOR IN THESE PLANS OR ANY FIELD CONDITIONS DISCOVERED BY CONTRACTOR THAT MAY DELAY OR OBSTRUCT THE PROPER COMPLETION OF THE WORK PER THESE PLANS SHALL BE BROUGHT TO THE ATTENTION OF THE CITY ENGINEER IMMEDIATELY UPON DISCOVERY. NOTIFICATION SHALL BE IN WRITING.
- DURING CONSTRUCTION, THE CONTRACTOR SHALL BE RESPONSIBLE FOR CONTROLLING NOISE, ODORS, DUST AND DEBRIS TO MINIMIZE IMPACTS ON SURROUNDING PROPERTIES AND ROADWAYS. CONTRACTOR SHALL BE RESPONSIBLE TO ASSURE THAT ALL CONSTRUCTION EQUIPMENT IS EQUIPPED WITH MANUFACTURERS APPROVED MUFFLER'S AND BAFFLES. FAILURE TO COMPLY MAY RESULT IN THE ISSUANCE OF A STOP WORK ORDER.
- IF HAZARDOUS MATERIALS ARE ENCOUNTERED DURING CONSTRUCTION, THE CONTRACTOR SHALL HALT CONSTRUCTION IMMEDIATELY, NOTIFY THE CITY ENGINEER, AND IMPLEMENT REMEDIATION AS DIRECTED BY THE CITY OR ITS AGENTS.
- PRIOR TO CONSTRUCTION, THE CONTRACTOR SHALL SUBMIT A TRAFFIC CONTROL PLAN FOR APPROVAL BY CITY STAFF THAT COMPLIES WITH THE CA-MUTCD.
- THE CONTRACTOR SHALL BE REQUIRED TO MAINTAIN TRAFFIC FLOW ON AFFECTED ROADWAYS DURING NON-WORKING HOURS, AND TO MINIMIZE TRAFFIC RESTRICTION DURING CONSTRUCTION. NO EXISTING STREET SHALL BE ALLOWED TO BE COMPLETELY CLOSED WITHOUT THE EXPRESSED WRITTEN PERMISSION OF THE CITY ENGINEER. ACCESS TO ALL PROPERTIES SHALL BE MAINTAINED THROUGH CONSTRUCTION.
- ALL EXISTING OR PROPOSED OVERHEAD AND UNDERGROUND UTILITIES SHALL BE PROTECTED THROUGHOUT THE CONSTRUCTION OF THE PROJECT IMPROVEMENTS.

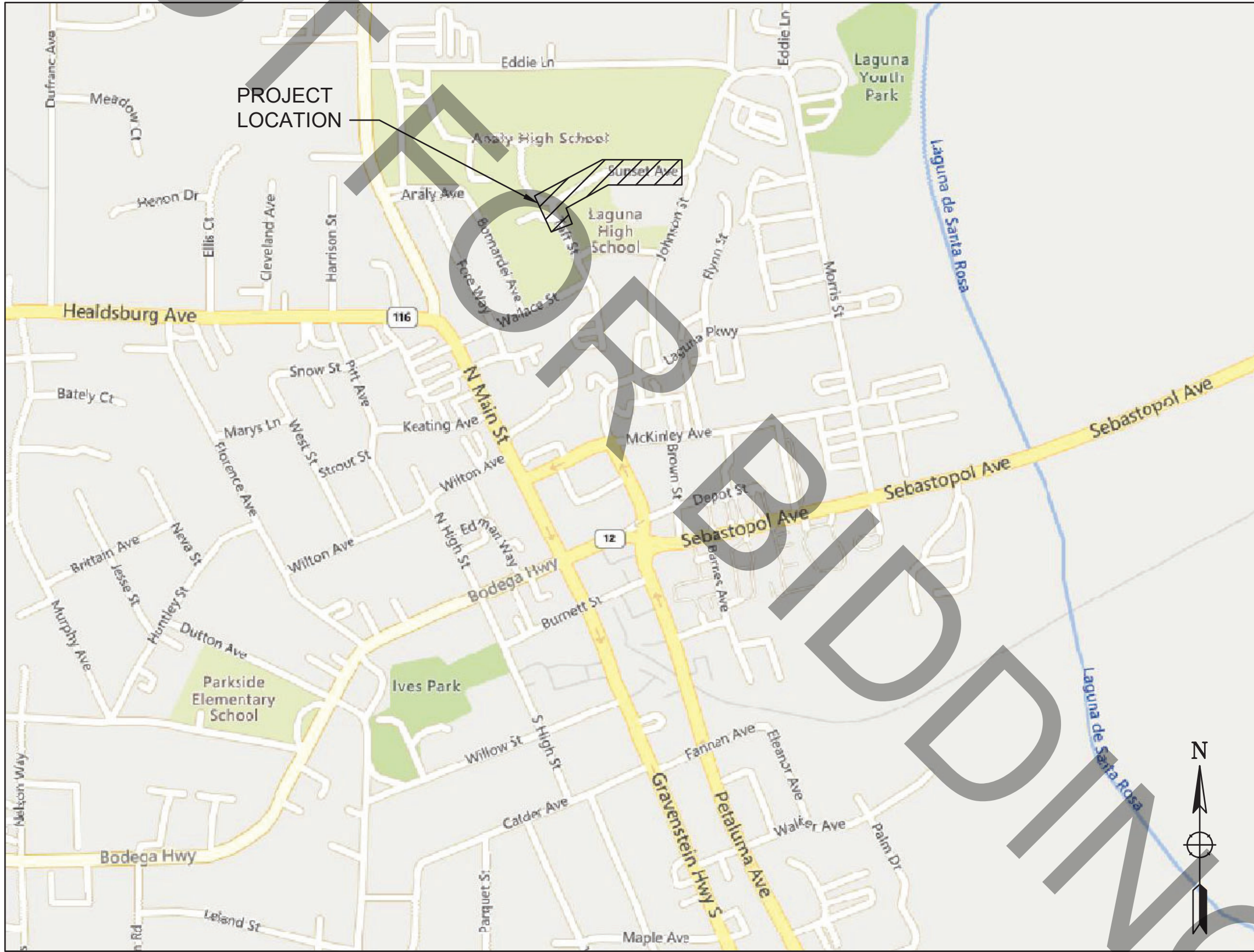

VICINITY MAP  
1"=500'

SHEET INDEX

DESCRIPTION	SHEET NO
TITLE SHEET	1
SIGNING & STRIPING PLAN	2
PAWB ASSEMBLY DETAILS	3
CURB RAMP SITE PLAN	4
CURB RAMP GRADING PLAN	5



UNDERGROUND SERVICE ALERT  
DIAL TOLL FREE  
1-800-227-2600  
OR 811  
AT LEAST TWO WORKING DAYS  
BEFORE DIGGING

PLANS APPROVED BY:

  
MARIO LANDEROS, CITY ENGINEER  
CITY OF SEBASTOPOL

03/06/24

DATE

Date	Revision	By

SCALE AS NOTED  
DATE 2/27/24  
JOB NO. SEB910  
DRAWING NUMBER

1 OF 5

SUNSET AVE/TAFT ST PEDESTRIAN CROSSING IMPROVEMENTS  
SUNSET AVE AT TAFT ST, ANALY HIGH SCHOOL  
SEBASTOPOL, CA

TITLE SHEET

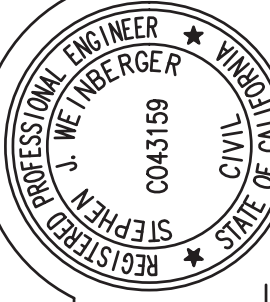

DESIGNED BY  
CUN

CHECKED BY  
SIW

DRAWN BY  
NGB

DATE  
02/27/2024

STEPHEN V. WEINBERGER R.C.E. NO. 43159



490 Mendocino Avenue, Suite 201  
Santa Rosa, CA 95401  
(707) 542-9500 Fax (707) 542-9590









Feb 21, 2024 - 12:40pm

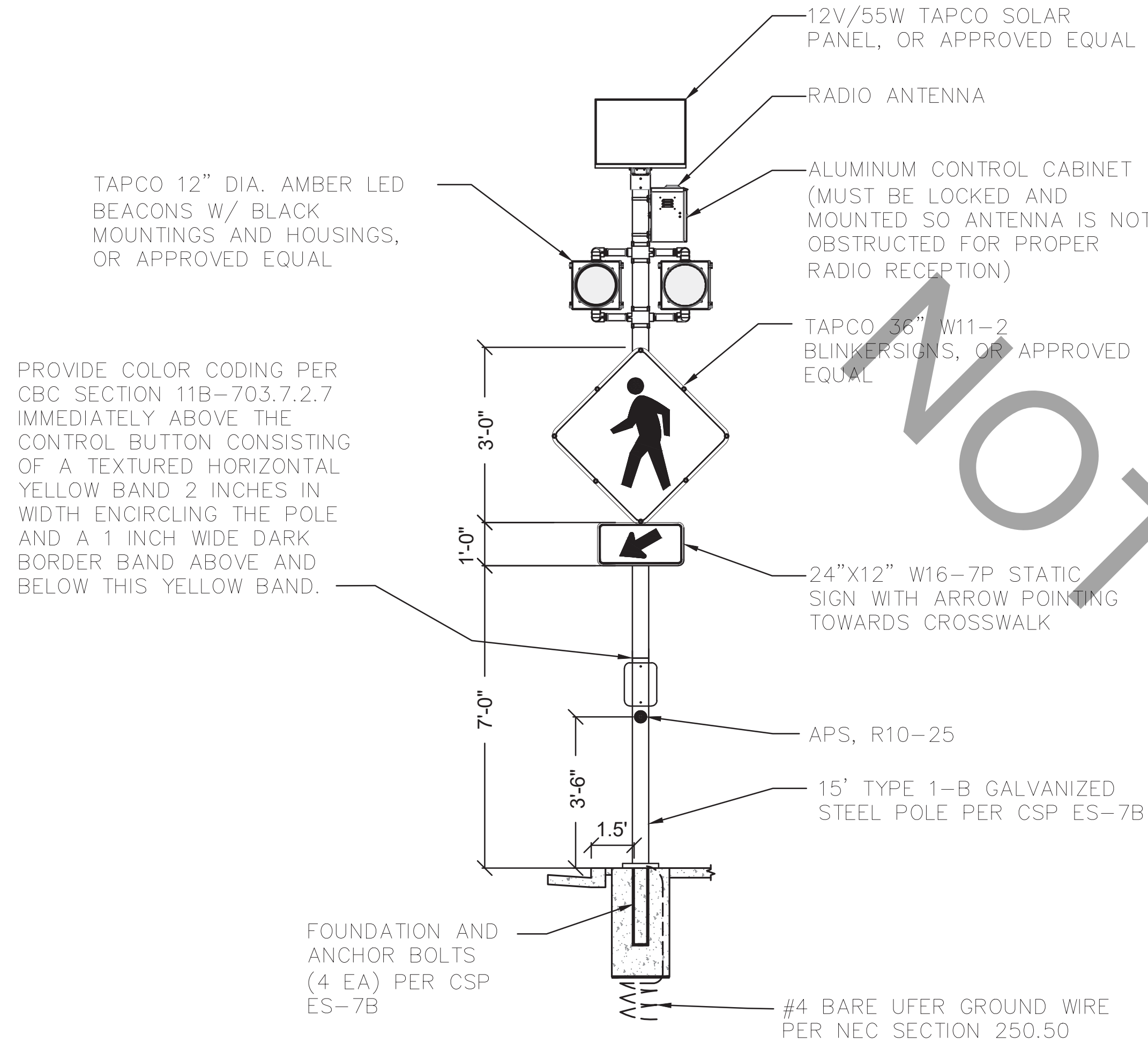

**DETAIL A: PEDESTRIAN ACTIVATED WARNING BEACON (PAWB)  
ASSEMBLY WITH APS AND CONTROLLER ON TYPE 1-B POLE**  
NOT TO SCALE

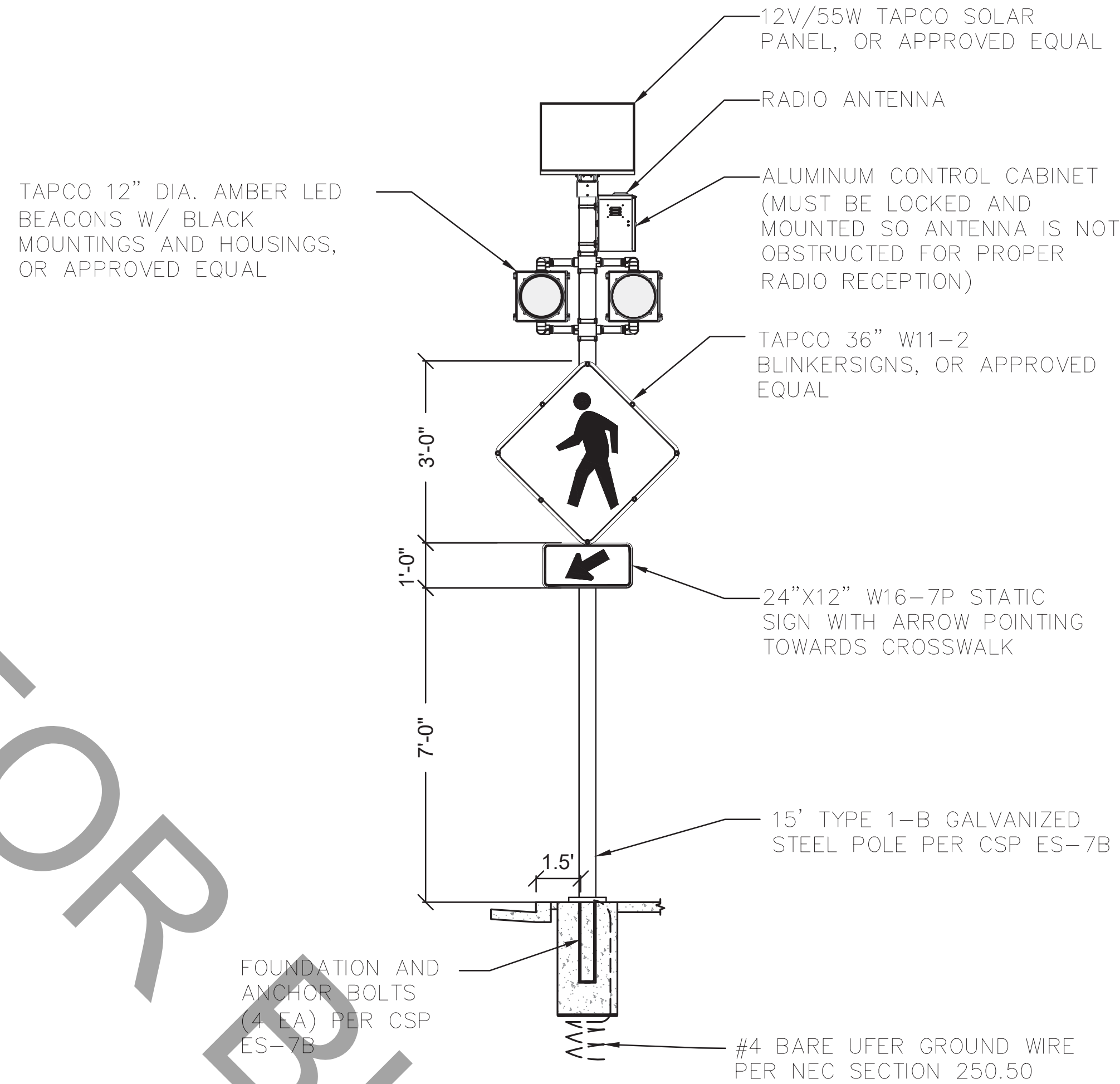

**DETAIL B: PEDESTRIAN ACTIVATED WARNING BEACON (PAWB)  
ASSEMBLY WITH CONTROLLER ON TYPE 1-B POLE**  
NOT TO SCALE

Date	Revision	By

SCALE	NTS
DATE	2/27/24
JOB NO.	SEB910
DRAWING NUMBER	

3 OF 5



Xrefs: COE-ENGINEERS STAMPS ONLY.dwg,COE-ENGINEERS NAMES ONLY.dwg,015072-TP.dwg,ACC-CA-PLS.dwg  
Images: SYS Signature-blue.png  
Path: F:\Civil 3d projects\015072\_analy sts\ped\DWG\015072-SP.dwg Layout Name: TAFT-SUNSET SITE PLAN Plot Date: Feb 20, 2024 at 11:00 am

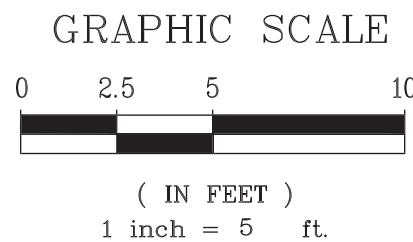
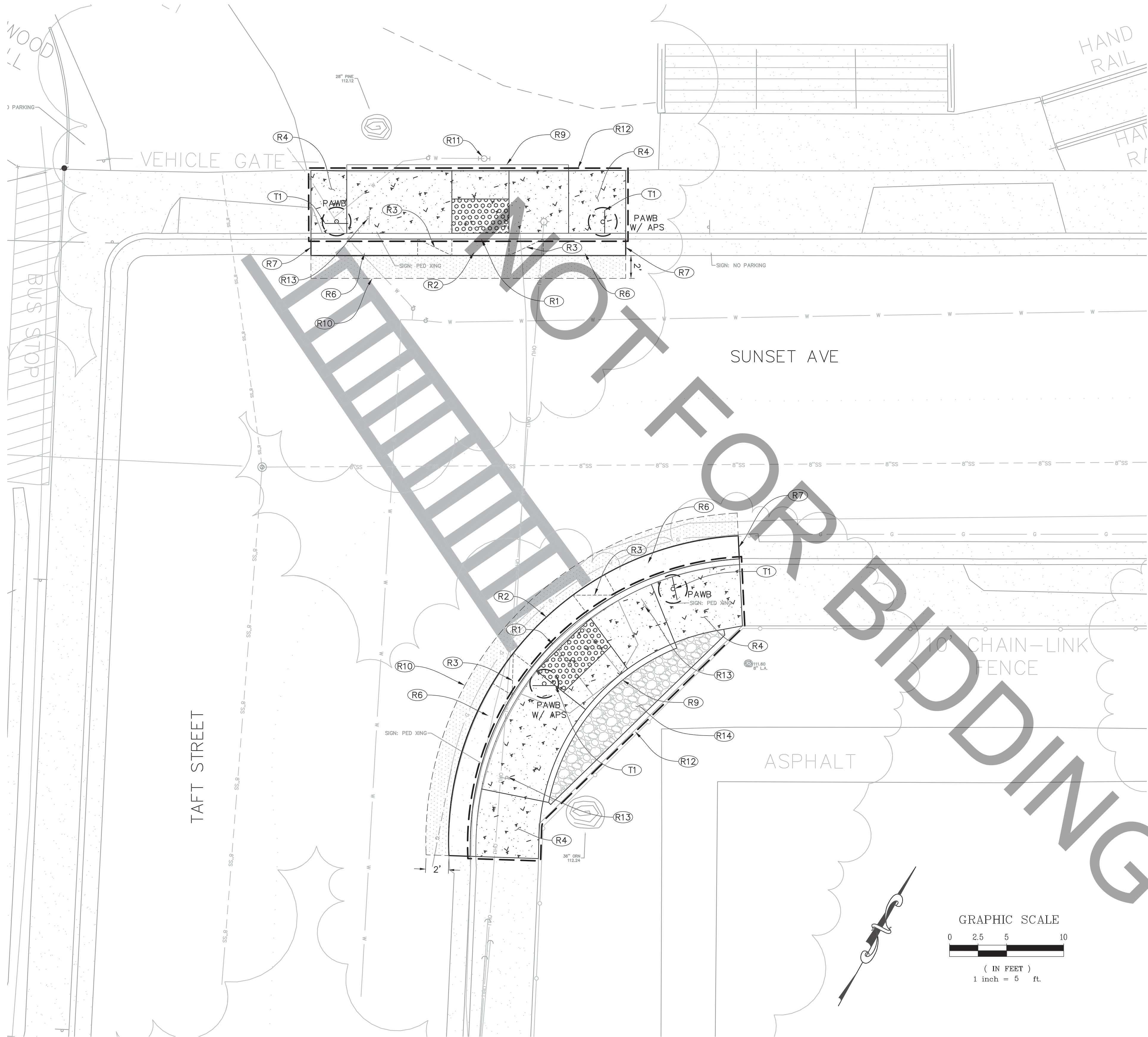

#### CONSTRUCTION NOTES:

- (R1) INSTALL CURB RAMP SIMILAR TO CASE C PER CALTRANS STD PLAN RSP A88A, PER FINISH GRADING PLAN AND CITY STD R2-1.
- (R2) INSTALL 24" GUTTER PAN, SLOPE SHALL NOT BE STEEPER THAN 5%.
- (R3) INSTALL 3' MINIMUM GUTTER SLOPE TRANSITION.
- (R4) INSTALL 5' LONG (OR NEAREST SCORE MARK) SIDEWALK TRANSITION.
- (R6) CONSTRUCT NEW CURB AND GUTTER PER CITY STD R-2.1.
- (R7) CONFORM TO EXISTING CURB AND GUTTER. INSTALL DOWELS PER DETAIL 1/4.
- (R9) INSTALL VERTICAL CURB AT BACK OF SIDEWALK PER CITY STD. R-2.1.
- (R10) SAWCUT & INSTALL 6" FULL DEPTH ASPHALT CONCRETE CONFORM, WITH A MINIMUM WIDTH OF 2-FT.
- (R11) PROTECT EXISTING FIRE HYDRANT IN PLACE.
- (R12) REMOVE EXISTING CONCRETE SIDEWALK.
- (R13) REMOVE AND SALVAGE EXISTING ROADSIDE SIGN AND POLE.
- (R14) INSTALL COBBLE NON-WALKABLE SURFACE PER DETAIL 1/5.
- (T1) SOLAR POWERED PEDESTRIAN ACTIVATED WARNING BEACON (PAWB) ASSEMBLY. SEE STRIPING PLANS.

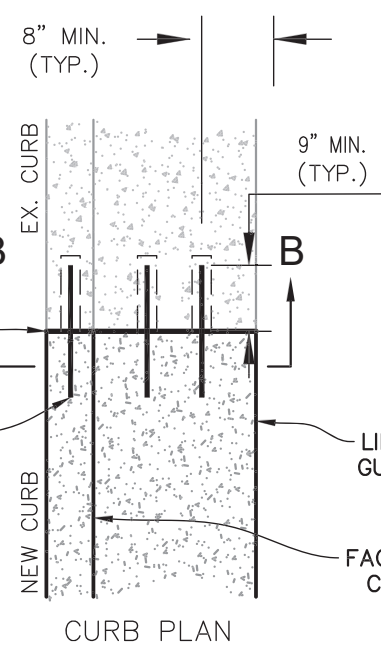
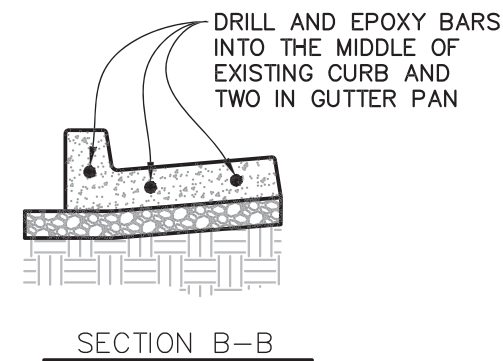
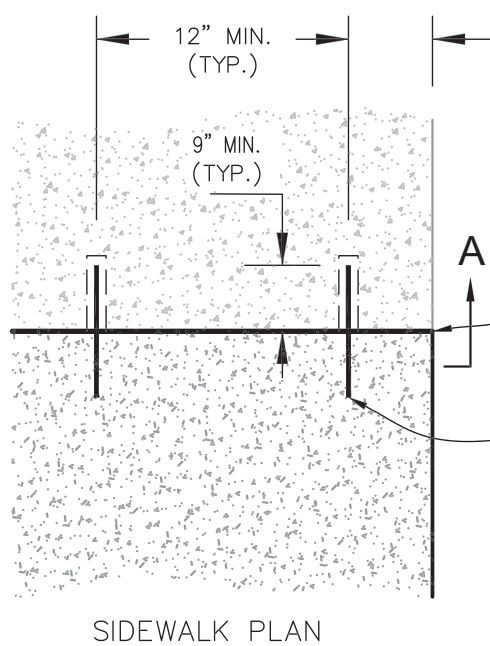
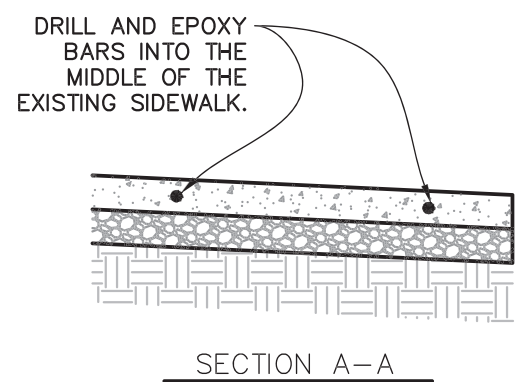

#### NOTES:

- CURB AND GUTTER AND SIDEWALK CONSTRUCTION SHALL CONFORM TO CITY STANDARD R-2.1.
- ALL SOFT OR SPONGY SUB-GRADE MATERIAL SHALL BE REMOVED AND REPLACED WITH SUITABLE MATERIAL AS REQUIRED BY THE ENGINEER.
- REINFORCING BARS SHALL BE MINIMUM GRADE 40 AND SHALL CONFORM TO SECTION 52, "REINFORCEMENT" OF THE CALTRANS STANDARD SPECIFICATIONS.
- EPOXY USED FOR BONDING REINFORCING BARS TO EXISTING CONCRETE SHALL CONFORM TO THE REQUIREMENTS OF SECTION 95, EPOXY AND SECTION 95-2.03, "EPOXY RESIN ADHESIVE FOR BONDING NEW CONCRETE TO OLD CONCRETE" OF THE CALTRANS STANDARD SPECIFICATIONS.
- SIDEWALK SHALL BE SAWCUT AND REMOVED TO THE NEAREST CONTROL JOINT (SCORE, EXPANSION OR WEAKENED PLANE JOINT). CURB AND GUTTER SHALL BE SAWCUT AND REMOVED TO THE NEAREST CONTROL JOINT WHEN PRACTICAL AS DIRECTED BY THE ENGINEER.
- WHEN TYING INTO EX. CURB AND GUTTER, THE EX. CURB AND GUTTER SHALL BE DOWELED WITH THREE #4 BARS WITH A MINIMUM OF 9-INCHES OF EMBEDMENT LENGTH.

#### SIDEWALK, CURB AND GUTTER REPLACEMENT DETAILS

NOT TO SCALE

1/4

Date	Revision	By

SCALE 1"=5'

DATE 2/27/24

JOB NO. SEB910

DRAWING NUMBER

4 OF 5

SUNSET AVE/TAFT ST PEDESTRIAN CROSSING IMPROVEMENTS  
SUNSET AVE AT TAFT ST, ANALY HIGH SCHOOL  
SEBASTOPOL, CA

TAFT-SUNSET SITE PLAN

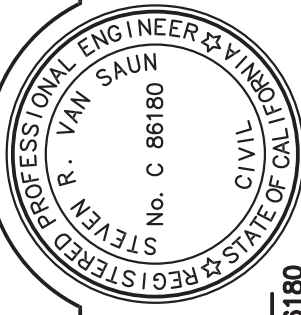

DRAWN BY  
PDT

DATE  
2/27/2024

COASTLAND | DCCM

COASTLAND | DCCM

1400 Neotomas Avenue

Santa Rosa, CA 95405

707.571.8005 | coastlandcivil.com



Xrefs: CCE-ENGINEERS STAMPS ONLY.dwg,CCE-ENGINEERS NAMES ONLY.dwg,015072-TP.dwg,ACC-CA-PLS.dwg  
Images: SYS Signature-blue.png  
Path: F:\Civil 3d projects\015072\_andy\hs\ped\DWG\015072-SP.dwg Layout Name: TAFT-SUNSET GRADING Plot Date: Feb 20, 2024 at 11:00 am

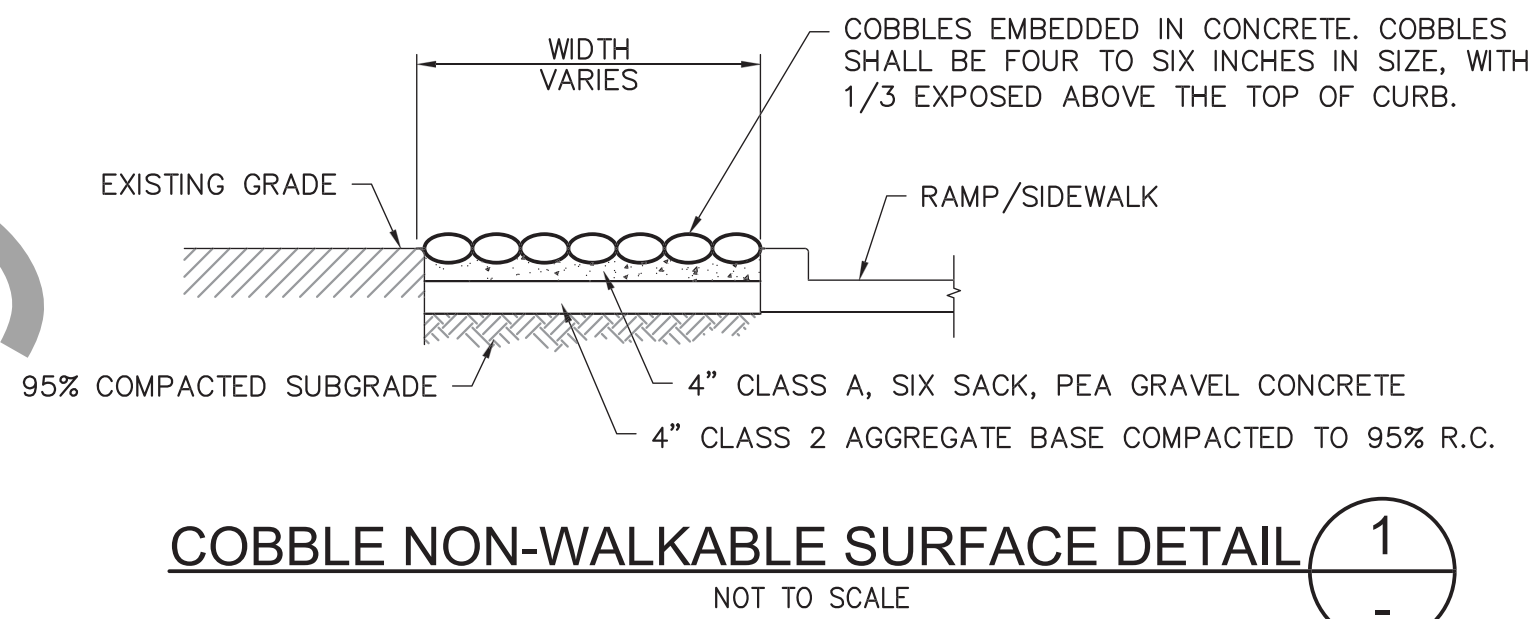
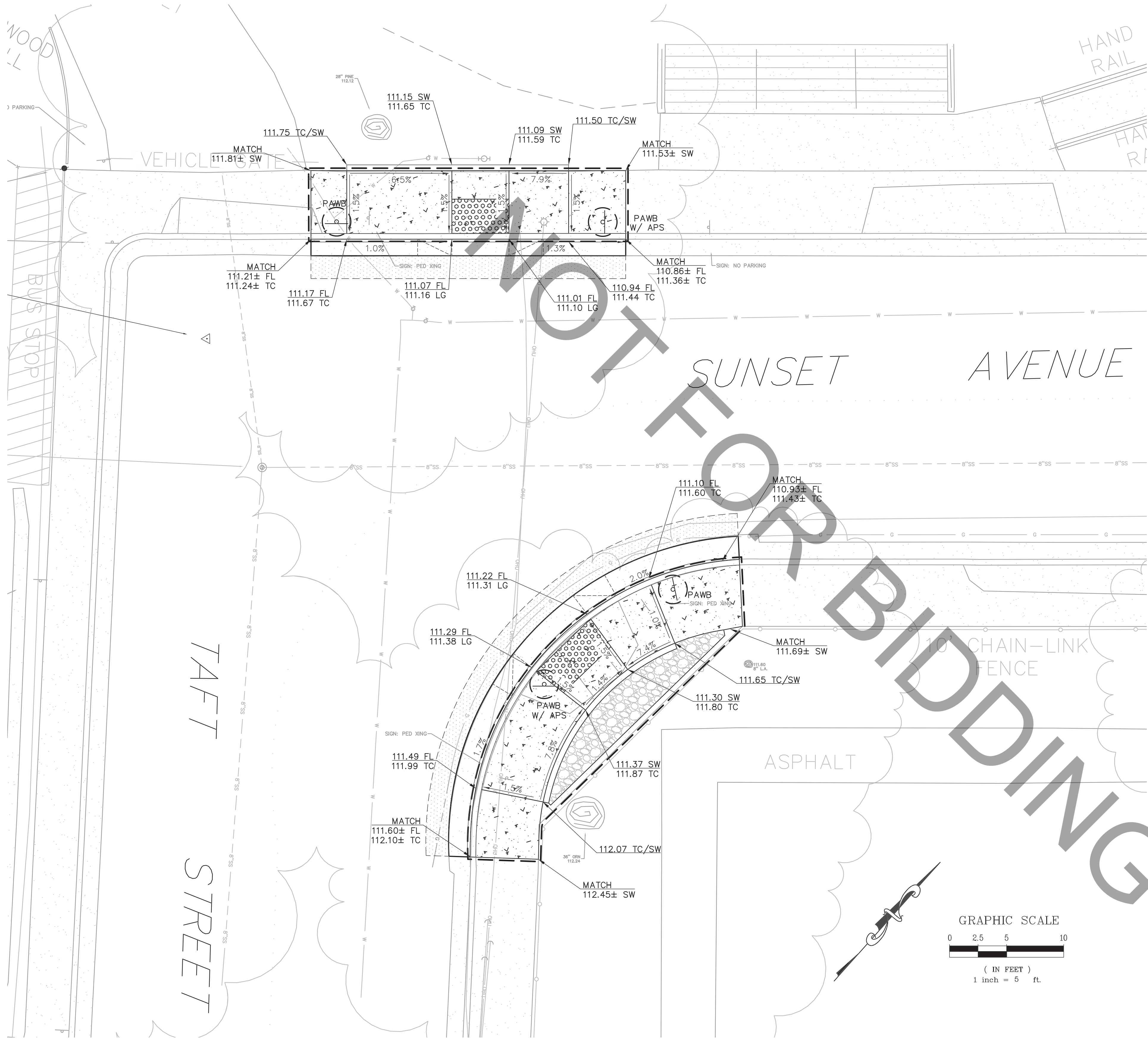

FOR REDUCED PLANS, THE ORIGINAL SCALE IS IN INCHES



COASTLAND | DCCM

COASTLAND | DCCM

1400 Neotomas Avenue

Santa Rosa, CA 95405

707.571.8005 | coastlandcivil.com

DRAWN BY

PDT

DESIGNED BY

PDT

CHECKED BY

SIRV



DATE

2/27/2024

SUNSET AVE/TAFT ST PEDESTRIAN CROSSING IMPROVEMENTS

SUNSET AVE AT TAFT ST, ANALY HIGH SCHOOL

SEBASTOPOL, CA

TAFT-SUNSET GRADING

SCALE 1"=5'

DATE 2/27/24

JOB NO. SEB910

DRAWING NUMBER

5 OF 5