

PLANT SCHEDULE

TREES	BOTANICAL NAME	COMMON NAME	SIZE	CONTAINER	QTY
	ACER X FREEMANII 'ARMSTRONG'	ARMSTRONG FREEMAN MAPLE	15 GAL		6
	CERCIS OCCIDENTALIS	WESTERN REDBUD MULTI-TRUNK	15 GAL	MULTI-STEM	9
	LAGERSTROEMIA X 'TUSCARORA'	CRAPE MYRTLE CORAL PINK	15 GAL		20
	PISTACIA CHINENSIS 'KEITH DAVEY'	KEITH DAVEY CHINESE PISTACHE	24" BOX		14
	PLATANUS RACEMOSA	CALIFORNIA SYCAMORE	24" BOX		3
	PLATANUS X ACERIFOLIA 'YARWOOD'	LONDON PLANE TREE	24" BOX		4
	QUERCUS LOBATA	VALLEY OAK	24" BOX		6
	QUERCUS RUBRA	RED OAK	24" BOX		13
GROUND COVERS	BOTANICAL NAME	COMMON NAME	QTY		
	SHRUB & GROUND COVER - LOW	LOW WATER USE PLANTING AREA	19,091 SF		
	SHRUB & GROUND COVER - MED	MEDIUM WATER USE PLANTING AREA	6,754 SF		
MATERIALS	BOTANICAL NAME	COMMON NAME	QTY		
	DECOMPOSED GRANITE	4" DEPTH	693 SF		
SOD	BOTANICAL NAME	COMMON NAME	QTY		
	TURF SOD BOLERO PLUS	FESCUE BLEND	253 SF		
	TURF SOD BIO-FILTRATION	BIOGRASS	5,789 SF		

PLANT SCHEDULE - proposed

Trees	Botanical Name	Common Name	Size	water	growth rate	size at 3-5 yrs	mature size HxW
	Acer x freemanii 'Armstrong'	Armstrong Freeman Maple	15 gal.	M	MED	25' x 15'	40x20'
	Cercis occidentalis	Western Redbud Multi trunk	15 gal.	L	SLOW	10' x 10'	15'x15'
	Lagerstroemia x 'Tuscarora'	Crape Myrtle Coral Pink	15 gal.	L	MED	10' x 10'	15'x15'
	Pistacia chinensis 'Keith Davey'	Keith Davey Chinese Pistache	24" box	L	SLOW	30' x 30'	50' x 50'
	Platanus x acerifolia 'Yarwood'	London Plane Tree	24" box	M	SLOW	30' x 30'	80' x 60'
	Quercus lobata	Valley Oak	24" box	L	SLOW	25' x 25'	80' x 80'
	Quercus rubra	Red Oak	24" box	M	SLOW	30' x 25'	60' x 50'
Shrubs	Botanical Name	Common Name	Size				
	Arctostaphylos densiflora 'Howard McMinn'	Howard McMinn Manzanita	5 gal.	L	MED	4' x 4'	6' x 6'
	Berberis thunbergii 'Crimson Pygmy'	Crimson Pygmy Barberry	5 gal.	L	MED	2' x 3'	3' x 4'
	Cercis occidentalis	Western Redbud Multi trunk	15 gal.	L	SLOW	10' x 10'	15'x15'
	Cistus x purpureus	Orchid Rockrose	5 gal.	L	MED	3' x 3'	5' x 5'
	Dodonaea viscosa 'Purpurea'	Purple Leafed Hopseed Bush	5 gal.	L	MED	6' x 4'	12' x 8'
	Leptospermum laevigatum 'Reevesii'	Dwarf Australian Tea Tree	5 gal.	L	MED	6' x 4'	8' x 6'
	Mahonia repens	Creeping Mahonia	1 gal.	L	MED	2' x 3'	3' x 4'
	Nandina domestica 'Gulf Stream' TM	Heavenly Bamboo	5 gal.	L	MED	3' x 2'	4' x 3'
	Pittosporum tobira 'Variegata'	Variegated Mock Orange	5 gal.	L	MED	3' x 3'	6' x 6'
	Prunus caroliniana 'Compacta'	Compact Carolina Cherry	5 gal.	L	MED	5' x 3'	8' x 6'
	Rhaphiolepis indica 'Ballerina'	Ballerina Indian Hawthorn	5 gal.	L	MED	2' x 3'	3' x 4'
	Sarcococca ruscifolia	Fragrant Sarcococca	5 gal.	L	MED	3' x 3'	5' x 5'
	Westringia fruticosa 'Morning Light'	Morning Light Coast Rosemary	5 gal.	L	MED	2' x 3'	3' x 5'
grasses	Botanical Name	Common Name	Size				
	Festuca mairei	Atlas Fescue	1 gal.	L	FAST	2' x 2'	2' x 2'
	Helictotrichon sempervirens	Blue Oat Grass	1 gal.	L	FAST	3' x 3'	3' x 3'
	Pennisetum orientale	Oriental Fountain Grass	1 gal.	L	FAST	3' x 3'	3' x 3'
Perennials	Botanical Name	Common Name	Size				
	Achillea x 'Moonshine'	Moonshine Yarrow	1 gal.	L	MED	1' x 2'	2' x 3'
	Anigozanthos x 'Bush Baby'	Bush Baby Kangaroo Paw	1 gal.	L	MED	2' x 2'	3' x 3'
	Dietsia bicolor	Fortnight Lily	1 gal.	L	FAST	3' x 3'	4' x 4'
	Salvia greggii 'Deep Red'	Autumn Sage	1 gal.	L	MED	3' x 3'	4' x 4'
	Tulbaghia violacea 'Variegata'	Striped Cape Garlic	1 gal.	L	MED	3' x 3'	3' x 3'
vines	Botanical Name	Common Name	Size				
	Macfadyena unguis cati	Yellow Trumpet Vine	5 gal.	L	FAST	15'	20'
	Parthenocissus tricuspidata 'Veitchii'	Boston Ivy	5 gal.	M	FAST	15'	20'
Ground Covers	Botanical Name	Common Name	Size	Spacing			
	Arctostaphylos uva ursi 'Point Reyes'	Kinnikinnick	1 gal. 36" o.c.	L	SLOW	<12"	
	Baccharis pilularis 'Twin Peaks #2'	Twin Peaks Coyote Brush	1 gal. 36" o.c.	L	MED	<24"	
	Helianthemum nummularium	Sunrose	1 gal. 36" o.c.	L	MED	<12"	
	Lantana montevidensis 'Purple'	Trailing Lantana	1 gal. 36" o.c.	L	FAST	<24"	
	Myoporum parvifolium 'Burgundy Carpet'	Trailing Myoporum	1 gal. 36" o.c.	L	FAST	<12"	
	Rosmarinus officinalis 'Huntington Carpet'	Huntington Carpet Rosemary	1 gal. 36" o.c.	L	MED	<18"	
	Turf Sod Bolero Plus	Fescue blend	sod	H	FAST		
	Turf Sod Bio Filtration	Biograss	sod	VL	FAST		

NOTES:

ALL PLANTINGS LOCATED ADJACENT TO A PARKING STALL WHEREVER THERE IS A BUMPER OVERHANG WILL BE LOW GROWING SO AS TO NOT IMPEDE THE FUNCTIONALITY OF THE PARKING. TYPICAL PLANT MATERIAL IS USUALLY GROUND COVER, FOR EXAMPLE TRAILING ROSEMARY (ROSMARINUS OFFICINALIS 'PROSTRATUS') OR LOW GROWING MANZANITA (ARCTOSTAPHYLOS UVA-URSI)

ANY PLANT MATERIAL PROPOSED TO BE PLANTED IN A STORM WATER TREATMENT AREA WILL BE AN APPROPRIATE SPECIES THAT IS ADAPTED TO THE WET TO DRY CONDITIONS. NOTE THAT ALL LANDSCAPE AREAS INCLUDING STORM WATER TREATMENT AREAS, WILL HAVE PERMANENT IRRIGATION SEPARATED INTO ZONES BASED ON THE WATER NEEDS OF THE PLANT MATERIAL WITHIN EACH ZONE

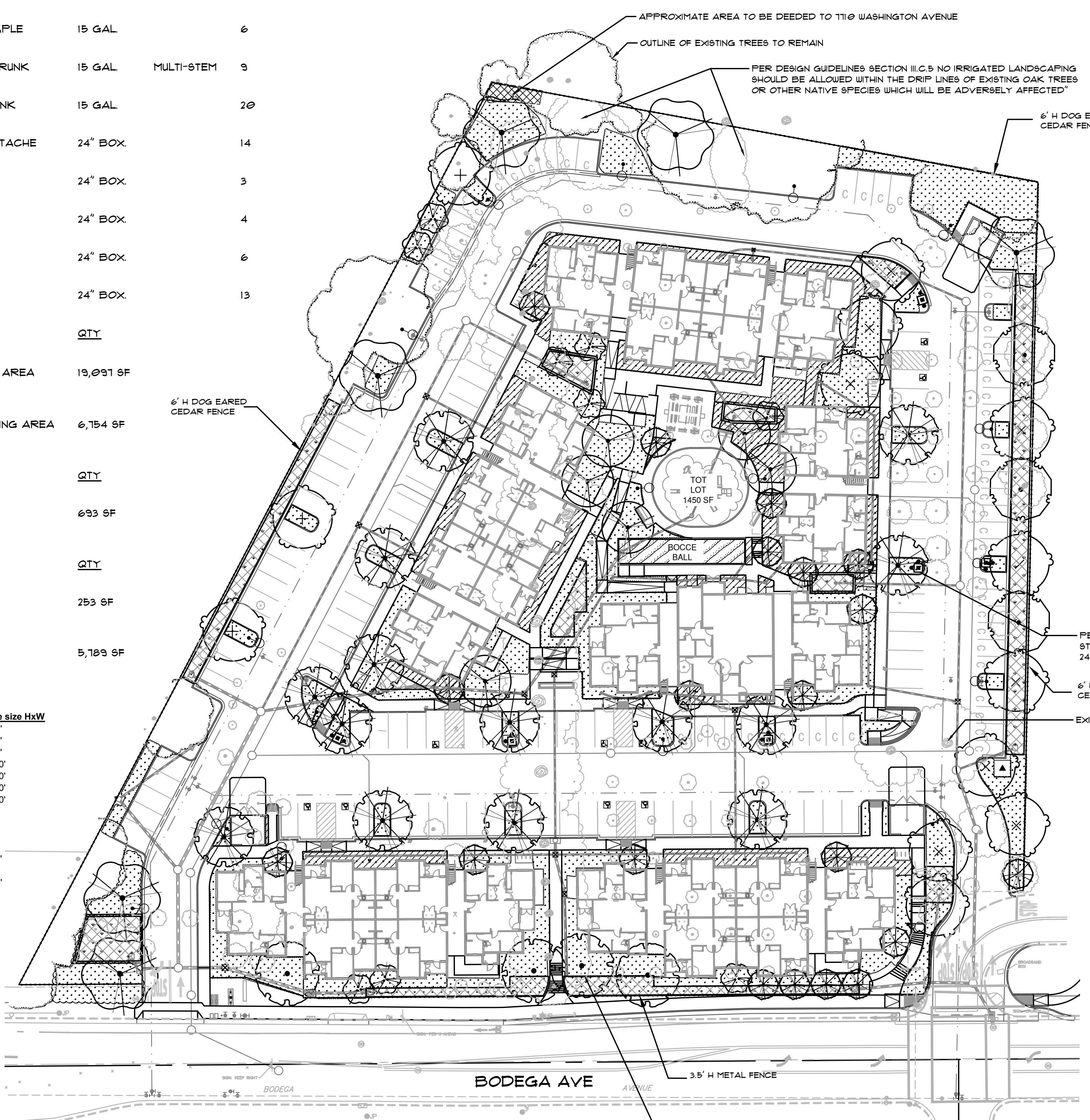

LANDSCAPE MASTER PLAN

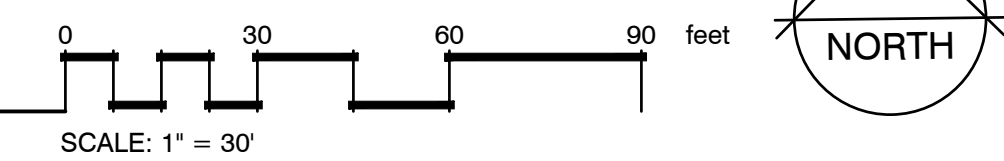

REVISIONS

--	--

COPYRIGHT DATE: 06/01/2022

DRAWN BY: THP

PROJECT #: PWH19-11

PACIFIC WEST ARCHITECTURE

THIS DRAWING CONTAINS INFORMATION WHICH IS THE PROPRIETARY PROPERTY OF DOUGLAS L. GIBSON, INC. NO PART OF THIS DRAWING IS TO BE REPRODUCED OR TRANSMITTED IN ANY FORM OR BY ANY MEANS, WITHOUT THE EXPRESS WRITTEN CONSENT OF DOUGLAS L. GIBSON, INC. THIS DRAWING IS TO BE USED ONLY FOR THE PROJECT AND CONSTRUCTION UNTIL IT IS SIGNED BY THE ARCHITECT. COPYRIGHT © BY PACIFIC WEST ARCHITECTURE

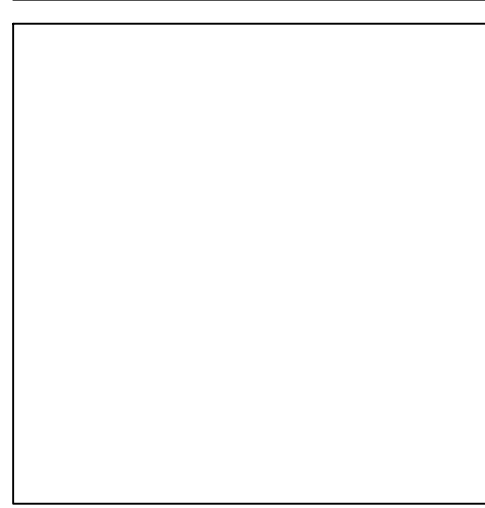

Pacific West Architecture

430 E. STATE STREET, SUITE 100
EAGLE, IDAHO 83616
PH: (208) 941-5267 FAX: (208) 461-5267

ALASKA - ARIZONA - CALIFORNIA - COLORADO - HAWAII - IDAHO - IOWA - KANSAS - LOUISIANA - MONTANA - NEVADA - NEW MEXICO - NORTH DAKOTA - OREGON - SOUTH DAKOTA - U.S.V.I. - UTAH - WASHINGTON - WYOMING

WOODMARK APARTMENTS

THOMAS H. PHELPS
LANDSCAPE ARCHITECTURE
THPLA, INC.

California Landscape Architect #4122
P.O. BOX 8328
Chico, CA 95927
(530) 892-8897 fax (530) 892-9588
thphelps@sbcglobal.net

PROJECT: 7716 BODEGA AVENUE SEBASTOPOL, CA

SCHMATIC SET / NOT FOR CONSTRUCTION